

# TOP SHELF, 1 FH (W 80 CM/D 42 CM) PRODUCT-DETAIL.MODEL-4121.610



## STANDARD VERSION

Body, 3-layer particle board (E1), melamine coated, highly abrasion-resistant, with 1 mm plastic edge, thickness 19 mm.  
The glued-in, 8 mm thick back panel gives the carcass its stability and strength.

**Note:** 1 folder height (OH)  $\hat{=}$  38.4 cm

## OPTIONS

- Decoration group 2
- Shelf (additional)

## CONFIGURATION

- Finishes | Finishes Price group 1, Finishes Price group 2

## STANDARD

DIN EN 14074, DIN EN 14073-2, DIN EN 14073-3, DIN EN 16121, DIN EN 16122

FEMB level:2017 (Level 3)

## TECHNICAL SPECIFICATIONS

FOLDER HEIGHT	1
WIDTH	80 cm
HEIGHT OF TOP CABINET	42 cm
HEIGHT OF COMBI TOP CABINET	78 cm
DEPTH	42 cm
NO. OF ADJUSTABLE SHELVES	0
NO. OF FIXED SHELVES	0
WEIGHT	2 kg

Our range of materials and colors can be found in the A2S material overview.



A2S-Furnishing Systems Ltd.  
ASS-Einrichtungssysteme GmbH  
info@ass.de  
WWW.A2S.COM

# TOP SHELF, 1 FH (W 80 CM/D 42 CM) PRODUCT-DETAIL.MODEL-4121.610



## BENEFITS/SPECIALS



Board material melamine  
coated with robust plastic edge

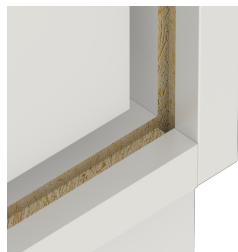

Resistance to warping due to 8  
mm thick back wall



Carcass firmly doweled and  
glued ex works