

HALL CUPBOARD, 5 OH (W 36 CM/D 58 CM), 4 SHELVES

PRODUCT-DETAIL.MODEL-6670.250



STANDARD VERSION

Note: 1 folder height (OH) $\hat{=}$ 38.4 cm

Base, body and shelves made of 3-layer chipboard (E1), melamine coated, material thickness 19 mm. Center layer B1 according to DIN 4102, body flame retardant. Base milled out at the rear as well as base adjusters in the cabinet sides. Body and shelves with 1 mm plastic edge, doors with 2 mm plastic edge. Door HPL-coated on both sides, thus particularly scratch-resistant. Door with continuous silver-colored aluminum handle strip. Flame-retardant version for use in public areas. Connected to each other with connecting screws. Optionally with lock, plate or pin cylinder.

OPTIONS

- Plate cylinder
- Lock with pin cylinder change core
- Front decors Price group 1
- Front decors price group 2

CONFIGURATION

- Finishes | Finishes Price group 1, Finishes Price group 2

STANDARD

FEMB level:2017 (Level 3)

GS-zertifiziert gem. DIN EN 15372:2017-02

TECHNICAL SPECIFICATIONS

FOLDER HEIGHT	5
WIDTH	36 cm
TOTAL HEIGHT	208 cm
DEPTH	08 cm
NO. OF ADJUSTABLE SHELVES	3
NO. OF FIXED SHELVES	1
WEIGHT	11 kg

Our range of materials and colors can be found in the A2S material overview.



A2S-Furnishing Systems Ltd.
ASS-Einrichtungssysteme GmbH
info@ass.de
WWW.A2S.COM

HALL CUPBOARD, 5 OH (W 36 CM/D 58 CM), 4 SHELVES

PRODUCT-DETAIL.MODEL-6670.250



BENEFITS/SPECIALS



Board material melamine coated with robust plastic edge

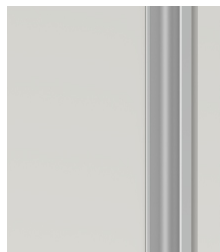

Cabinet-height handles keep the escape route clear and are easy to reach from any height.



In 3 different equipment variants.



Pull-out proof shelf supports



Support panel material flame-retardant according to DIN 4102 B1

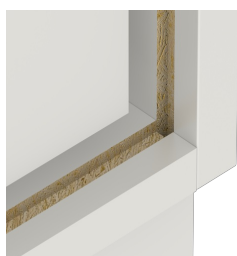

Resistance to warping due to 8 mm thick back wall



Carcass firmly doweled and glued ex works