

HALL CUPBOARD, 5 OH (W 48 CM/D 58 CM), 1-DOOR, WITH COAT HOOKS, TIDY BOXES

PRODUCT-DETAIL.MODEL-6671.950

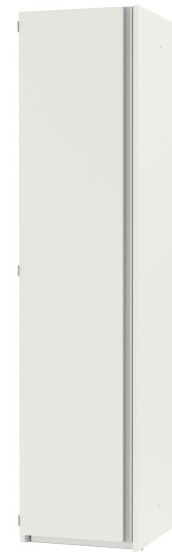

STANDARD VERSION

Note: 1 folder height (OH) $\hat{=}$ 38.4 cm

Hallway cabinet 5 OH, 1 door; 1 large tidy box at the bottom and a choice of 2 large tidy boxes or 4 small tidy boxes or 1 large tidy box and 2 small tidy boxes.

Material Body, base and shelves made of 3-layer chipboard (E1), melamine-coated, thickness 19 mm. Body and shelves with 1 mm plastic edge, doors with 2 mm plastic edge. Door coated with HPL on both sides, making it particularly scratch-resistant. Door with continuous aluminium handle strip in silver. Support plate material and decor in pure white U400, flame-retardant for use in public areas.

Elements connected to each other with connecting screws.

OPTIONS

- Plate cylinder
- Lock with pin cylinder change core
- Front decors Price group 1
- Front decors price group 2

STANDARD

FEMB level:2017 (Level 3)

GS-zertifiziert gem. DIN EN 15372:2017-02

TECHNICAL SPECIFICATIONS

FOLDER HEIGHT	5
WIDTH	48 cm
TOTAL HEIGHT	198 cm
DEPTH	48 cm
NO. OF FIXED SHELVES	2
WEIGHT	18 kg

Our range of materials and colors can be found in the A2S material overview.



A2S-Furnishing Systems Ltd.
 ASS-Einrichtungssysteme GmbH
 info@ass.de
 WWW.A2S.COM

HALL CUPBOARD, 5 OH (W 48 CM/D 58 CM), 1-DOOR, WITH COAT HOOKS, TIDY BOXES

PRODUCT-DETAIL.MODEL-6671.950



BENEFITS/SPECIALS



Board material melamine coated with robust plastic edge

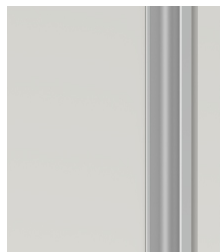

Cabinet-height handles keep the escape route clear and are easy to reach from any height.



In 3 different equipment variants.



Pull-out proof shelf supports



Support panel material flame-retardant according to DIN 4102 B1

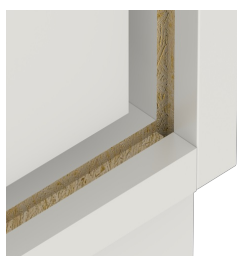

Resistance to warping due to 8 mm thick back wall



Carcass firmly doweled and glued ex works