

MATERIAL CUPBOARD, 5 OH (W 104 CM/D 48 CM), WITH TIDY BOXES

MODEL 4013.650



STANDARD VERSION

Body, 3-layer particle board (E1), melamine coated, highly abrasion-resistant, with 1 mm plastic edge, thickness 19 mm.

Rear panel, 3-layer chipboard (E1), melamine-coated, highly abrasion-resistant, grooved all around, thickness 8 mm.

Back panel, 3-layer chipboard (E1), melamine coated, highly abrasion-resistant, grooved all around, thickness 8 mm.

Note: 1 folder height (OH) $\hat{=}$ 38.4 cm

The color assortment for the Tidy Boxes can be selected as desired. Please specify when ordering.

Optionally with 12 large or 24 small tidy boxes.

OPTIONS

- Decoration group 2
- Base adjustment
- Steel base (chrome silver 9006)

STANDARD

GS zertifiziert gem. DIN EN 16121:2024-04

TECHNICAL SPECIFICATIONS

FOLDER HEIGHT	5
WIDTH	104 cm
TOTAL HEIGHT	204 cm
DEPTH	50 cm
NO. OF ADJUSTABLE SHELVES	2
NO. OF FIXED SHELVES	1
WEIGHT	112 kg

Our range of materials and colors can be found in the A2S material overview.



A2S-Furnishing Systems Ltd.
ASS-Einrichtungssysteme GmbH
info@a2s.com
WWW.A2S.COM

MATERIAL CUPBOARD, 5 OH (W 104 CM/D 48 CM), WITH TIDY BOXES MODEL 4013.650



BENEFITS/SPECIALS



Board material melamine
coated with robust plastic edge

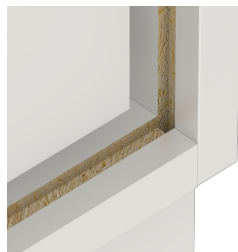

Resistance to warping due to 8
mm thick back wall



Carcass firmly doweled and
glued ex works



robust Tidy Boxes