

STANDARD VERSION

Body, 3-layer particle board (E1), melamine coated, highly abrasion-resistant, with 1 mm plastic edge, thickness 19 mm.

Rear panel, 3-layer chipboard (E1), melamine-coated, highly abrasion-resistant, grooved all around, thickness 8 mm.

Back panel, 3-layer chipboard (E1), melamine coated, highly abrasion-resistant, grooved all around, thickness 8 mm.

Lockable, with center panel.

Note: 1 folder height (OH) \pm 38.4 cm

Cabinet including base.

Handle strip aluminum-silver colored. Delivery partly assembled.

OPTIONS

- Decoration group 2
- Front HPL glued
- Shelf (additional)
- Front decors price group 2
- Front white, writable

STANDARD

FEMB level:2017 (Level 3)

DIN EN 14074, DIN EN 14073-2, DIN EN 14073-3, DIN EN 16121, DIN EN 16122

TECHNICAL SPECIFICATIONS

FOLDER HEIGHT	5
WIDTH	94.49 "
TOTAL HEIGHT	80.31 "
DEPTH	24.41 "
NO. OF ADJUSTABLE SHELVES	6
NO. OF FIXED SHELVES	2
WEIGHT	220 lb

BENEFITS/SPECIALS



Board material melamine coated with robust plastic edge



Pull-out proof shelf supports



Sliding doors lockable



1 OH cabinet with handle or lock



Carcass firmly dowelled and glued ex works

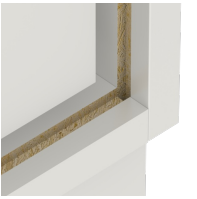

Resistance to warping due to 8 mm thick back wall



Smooth sliding doors