

# HALLWAY UPPER CABINETS MODEL FLURMÖBELSYSTEM



## STANDARD VERSION

Top unit for hall cupboard

Material Body, plinth and shelves made of 3-layer chipboard (E1), melamine resin-coated, thickness 19 mm. Center layer B1 according to DIN 4102. 1 mm plastic edge on body and shelves, 2 mm plastic edge on doors. HPL-coated door on both sides, making it particularly scratch-resistant. Door with continuous silver-colored aluminium handle strip. White decor finish: flame-retardant for use in public areas.

Note: 1 folder height (OH)  $\pm$  38.4 cm

## OPTIONS

- Front decors Price group 1
- Front decors price group 2
- Plate cylinder
- Lock with pin cylinder change core

## STANDARD

FEMB level:2017 (Level 3)

GS-zertifiziert gem. DIN EN 15372:2017-02

## TECHNICAL SPECIFICATIONS

FOLDER HEIGHT	1	2	1	2
WIDTH	14.17 "	14.17 "	18.90 "	18.90 "
HEIGHT OF TOP CABINET	15.75 "	31.10 "	15.75 "	31.10 "
DEPTH	22.83 "	22.83 "	22.83 "	22.83 "
NO. OF ADJUSTABLE SHELVES	0	1	0	1
NO. OF FIXED SHELVES	0	0	0	0
WEIGHT	31 lb	53 lb	36 lb	64 lb

Our range of materials and colors can be found in the A2S material overview.



A2S-Furnishing Systems Ltd.  
ASS-Einrichtungssysteme GmbH  
info@a2s.com  
WWW.A2S.COM

# HALLWAY UPPER CABINETS MODEL FLURMÖBELSYSTEM



## BENEFITS/SPECIALS



Board material melamine coated with robust plastic edge

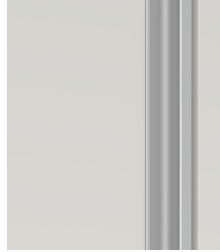

Cabinet-height handles keep the escape route clear and are easy to reach from any height.



Support panel material flame-retardant according to DIN 4102 B1

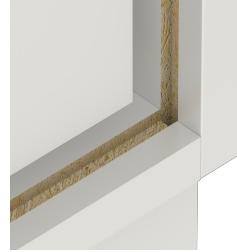

Resistance to warping due to 8 mm thick back wall



Carcass firmly doweled and glued ex works