



STANDARD VERSION

Note: 1 folder height (OH) \triangleq 38.4 cm

5 FH, 1-door. 1 fixed shelf on the top, 1 fixed construction shelf on the bottom. 1 large Tidy Box or 2 small Tidy Boxes under the construction shelf. Suitable for stool model 6690.200.

OPTIONS

- Stool with storage compartment and recessed grip under the seat.
- Lock with pin cylinder change core
- Front decors price group 2
- Plate cylinder
- Front decors Price group 1

STANDARD

FEMB level:2017 (Level 3)

GS-zertifiziert gem. DIN EN 15372:2017-02

TECHNICAL SPECIFICATIONS

FOLDER HEIGHT	5
WIDTH	14.17 "
TOTAL HEIGHT	80.31 "
DEPTH	22.83 "
NO. OF FIXED SHELVES	2
WEIGHT	137 lb

BENEFITS/SPECIALS



Board material melamine coated with robust plastic edge



Cabinet-height handles keep the escape route clear and are easy to reach from any height.



In 3 different equipment variants.



Pull-out proof shelf supports



Pull-out stool that provides non-slip support.



Support panel material flame-retardant according to DIN 4102 B1

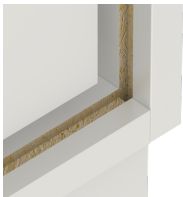

Resistance to warping due to 8 mm thick back wall



Carcass firmly dowelled and glued ex works