

TOP SHELF, MULTIFUNCTIONAL BOARD SYSTEM, WITHOUT CENTER PANEL (W 70 CM)

MODEL 4731.070



STANDARD VERSION

Body, 3-layer particle board (E1), melamine coated, highly abrasion-resistant, with 1 mm plastic edge, thickness 19 mm.

Rear panel, 3-layer chipboard (E1), melamine-coated, highly abrasion-resistant, grooved all around, thickness 8 mm.

Back panel, 3-layer chipboard (E1), melamine coated, highly abrasion-resistant, grooved all around, thickness 8 mm.

With possibility to attach the aluminum guide rail for multifunctional panel system.

OPTIONS

- Decoration group 2
- Shelf (additional)

STANDARD

FEMB level:2017 (Level 3)

Our range of materials and colors can be found in the A2S material overview.



A2S-Furnishing Systems Ltd.
ASS-Einrichtungssysteme GmbH
info@a2s.com
WWW.A2S.COM

TOP SHELF, MULTIFUNCTIONAL BOARD SYSTEM, WITHOUT CENTER PANEL (W 70 CM)

MODEL 4731.070



BENEFITS/SPECIALS



Board material melamine coated with robust plastic edge

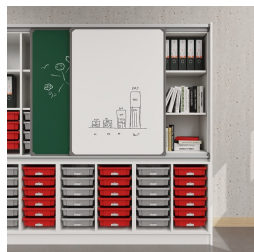

Sliding panel with aluminum guide rails and additional storage space behind the panels



Shelf attachment with tidy boxes behind the panels



Pull-out proof shelf supports

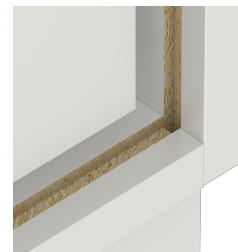

Resistance to warping due to 8 mm thick back wall



Carcass firmly dowelled and glued ex works